

VENETIAN[®]
BY THOR MOTOR COACH



 **THOR**[®]
MOTOR COACH

Made to fit.

When we say
Made to Fit
we mean it.

With so many unique models available, Thor Motor Coach motorhomes are priced to fit anyone's budget – from families buying their first motorhome to full-timers looking for a roaming “dream home”.

No matter how you choose to spend your time or your money, there's a TMC motorhome that fits your needs.

Welcome to the **Venetian**, the motorhome that is ***Made to Fit*** your desires.



ALL FLOOR PLANS FEATURE TILT/TELESCOPING STEERING COLUMN & VIP SMART WHEEL



See what's new on the
Venetian for 2017.



M37 | BISTRO | RESORT CHERRY | BUFFET DINETTE & SOFA BED W/RETRACTABLE 55" LED SMART HDTV

Relax & Unwind

Thanks to a bed that was inspired by your own, **Venetian** bedrooms boast a Denver Mattress® and elegant design.

You can also find plenty of areas to relax, unwind and get a good night's rest for the next day's adventures.



M37 | BISTRO | RESORT CHERRY | BUFFET DINETTE & SOFA BED W/RETRACTABLE 55" LED SMART HDTV



G36 | ELECTRIC FIREPLACE



OPTIONAL OVERHEAD BUNK IN ALL FLOOR PLANS



M37 | RECLINING THEATER SEATING



Check out an extended overview of the Venetian.

Floor Plans

G36

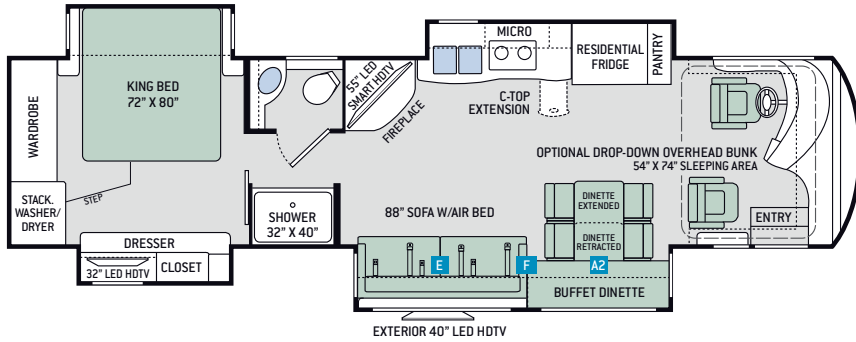

A40

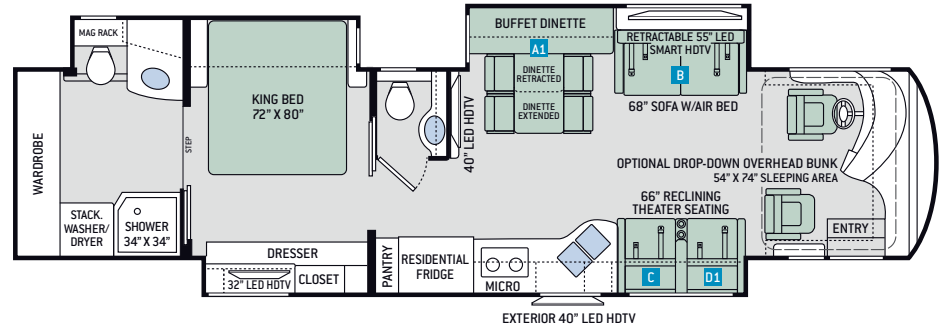

M37

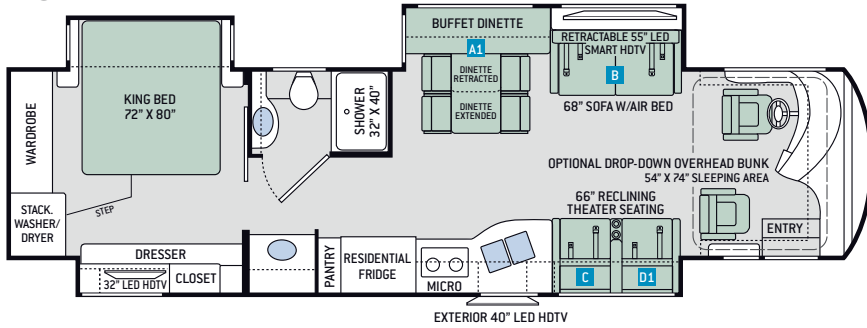

T42

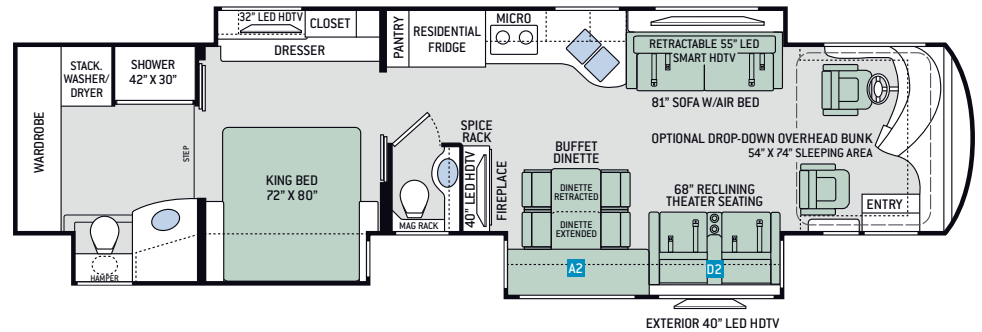

OPTIONS

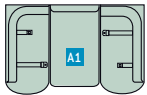

OPTIONAL 74" DREAM DINETTE



OPTIONAL 74" DREAM DINETTE

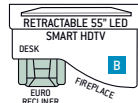

OPTIONAL EURO RECLINER w/DESKTOP & FIREPLACE

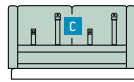

PASSENGER SIDE 66" SOFA w/AIR BED (EURO RECLINER w/DESKTOP & FIREPLACE REQUIRED)

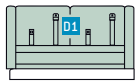

OPTIONAL PASSENGER SIDE 66" JACK-KNIFE SOFA

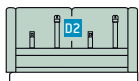

OPTIONAL PASSENGER SIDE 68" JACK-KNIFE SOFA

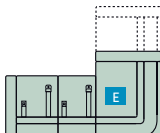

OPTIONAL 88" X 75" EXPANDING SOFA w/AIR BED

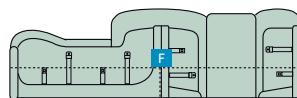

OPTIONAL 162" SOFA ENSEMBLE INCLUDES 88" SOFA w/AIR BED & 74" DREAM DINETTE

Specifications

	G36	M37	A40	T42
Chassis	Freightliner XC-R	Freightliner XC-R	Freightliner XC-R	Freightliner XC-R
Gross Vehicle (GVWR)	38,320	38,320	38,320	44,700
Gross Combined (GCWR)	48,320	48,320	48,320	59,700
Wheel Base	236"	242"	272"	266"
Exterior Length	37'-11"	38'-5"	40'-11"	42'-5"
Exterior Height (w/AC)	12'-7"	12'-7"	12'-7"	12'-7"
Exterior Width (w/o mirrors)	101"	101"	101"	101"
Interior Height (living area)	84"	84"	84"	84"
Awning Size	13'-1"	16'-5"	16'-5"	(2) 12'
Fuel (gal)	150	150	150	150
LPG (lbs)	104	104	104	104
Fresh/Waste/Gray Water (gal)	91 / 51 / 51	91 / 51 / 51	91 / 51 / 51	91 / 51 / 51
Water Heater (gal)	10	10	10	10
Furnace (BTUs)	35,000	(2) 20,000	(1) 20,000 & (1) 25,000	(2) 25,000
Exterior Storage Capacity (cu. ft.)	185	185	225	215

Interior Decor



BISTRO



COASTAL



STRATA



HIGH-GLOSS GLAZED MILAN CHERRY



HIGH-GLOSS GLAZED PACIFIC CHERRY



HIGH-GLOSS GLAZED RESORT CHERRY



KITCHEN & BATH COUNTERTOPS



BEDROOM COUNTERTOP

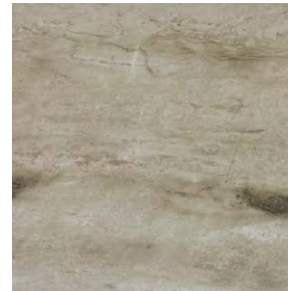

POLISHED PORCELAIN TILE FLOORING

Exterior Graphics



CASABLANCA FULL-BODY PAINT

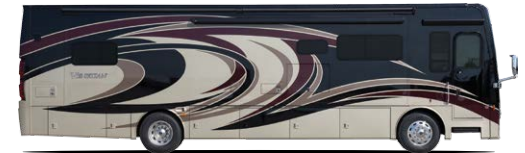

DYNASTY FULL-BODY PAINT



GOLD COAST FULL-BODY PAINT



SENTRY FULL-BODY PAINT

Meals *Your Way*, While You're Away

Whether you're preparing a home cooked meal or storing leftovers from that great local restaurant, the well-equipped kitchen will keep you happy and healthy. The **Venetian** features an electric induction cooktop, convection microwave oven, and plenty of working space on the solid surface countertops.



STAINLESS STEEL RESIDENTIAL REFRIGERATOR
WITH IN-DOOR ICE & WATER DISPENSER



M37 | BISTRO | RESORT CHERRY | BUFFET DINETTE



Have Questions?
Contact our Coach Link Team.

Coach  LINK

G36 | BISTRO | PACIFIC CHERRY | OPTIONAL SOFA & DREAM DINETTE ENSEMBLE



ATLASTM

FOUNDATION

Laying the Groundwork for Safe Travels

The Atlas FoundationTM is the premier building platform and substructure in the industry. Thor Motor Coach has partnered with industry leaders, Freightliner[®] Custom Chassis and MORryde[®] International, to bring you this innovative building design.

Innovation doesn't just happen, it takes a dedicated team of the very best designers and engineers working together to tackle the challenges in the road ahead. From the very start our main focus is you, and you will see that from the moment you step into the motorhome.

The Atlas FoundationTM is a fully integrated basement foundation design. This means that trusses, cross members and ladder assemblies are pre-formed and laser-cut from high-strength, 50 grade HSLA steel, which provides greater resistance to corrosion than carbon steel.

The structure is assembled and welded on a flat, laser-leveled table, then hoisted onto the OEM chassis and welded into place. This system includes a built-in, unit floor leveling system, which

maintains the true squareness of the motorhome body and helps prevent crowning.

Fiberglass lined, pass-through storage bays span the width of the unit with steel support under each of the compartments. The steel sub-frame can support more than 1,000 pounds per compartment. Designed to facilitate greater luminosity, the interior mold and mildew resistant fiberglass lining is white, making it easier to see within the compartment in low-light situations.

Built strong and insulated to help reduce heat transfer, the firewall and rear engine cage are fully encased in steel, which eliminates engine and road noise.

You're the one who will rely on our innovation for years to come. You're the one who will feel the strength of the Atlas FoundationTM as you drive the open road. You're the one who will benefit from our hard work and commitment to excellence.

We didn't just design the Atlas FoundationTM, we crafted it to fit you.



Check out the in-depth video of the Atlas Foundation™.

A home needs a strong foundation and that is especially true for the home that rolls down the road. The Atlas™ Foundation under the Venetian provides an excellent base to construct your new motorhome.

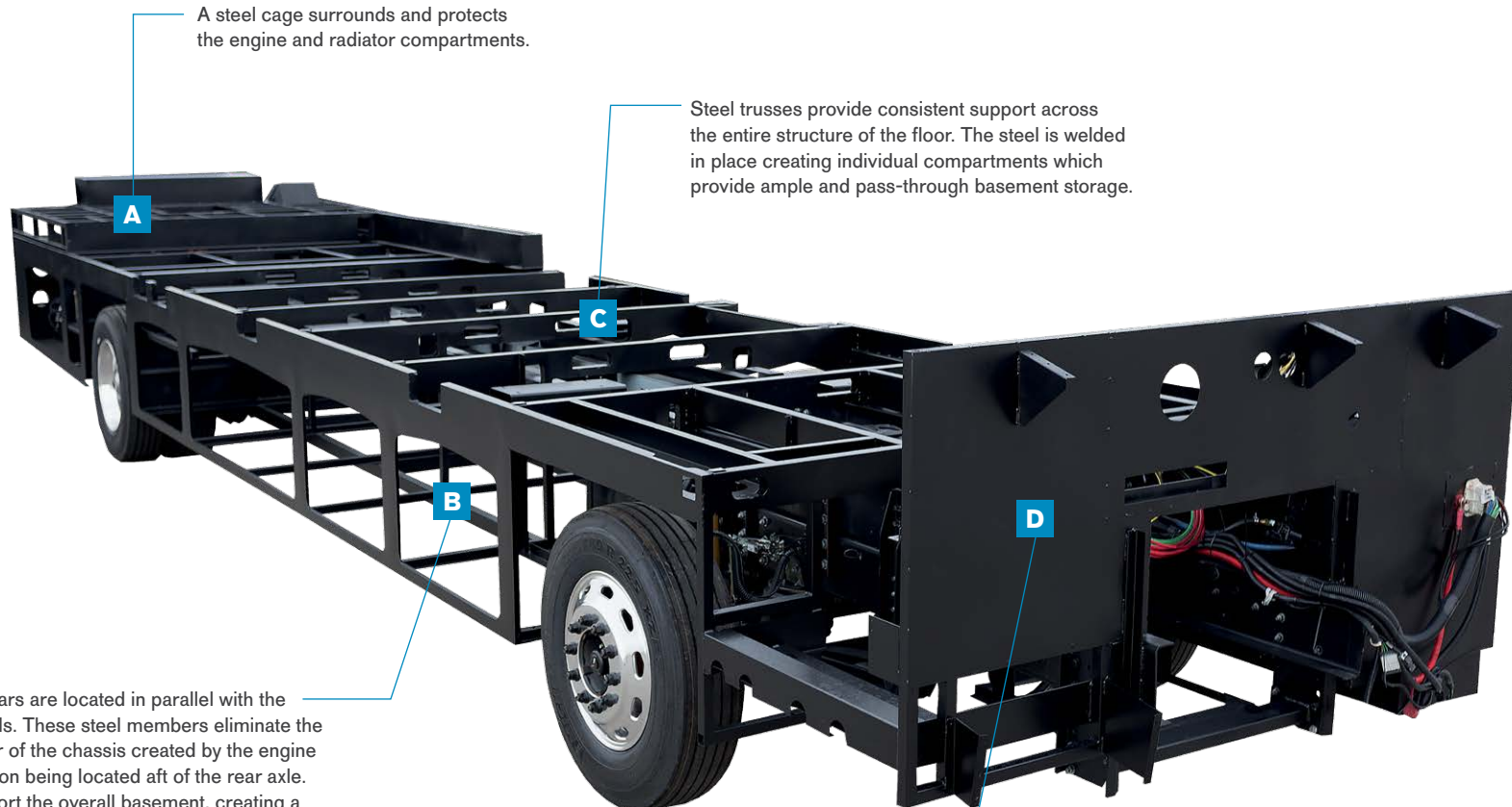

A steel cage surrounds and protects the engine and radiator compartments.

Steel trusses provide consistent support across the entire structure of the floor. The steel is welded in place creating individual compartments which provide ample and pass-through basement storage.

Anti-camber bars are located in parallel with the main frame rails. These steel members eliminate the natural camber of the chassis created by the engine and transmission being located aft of the rear axle. The bars support the overall basement, creating a true structure to mount the house of the motorhome.

The steel firewall protects the front of the coach while providing a strong anchor point for the cockpit. Solid foam insulation is added to provide a buffer to eliminate road noise and help prevent heat and cold transfer.



Features

CONSTRUCTION & EXTERIOR

- Freightliner® XC-R Raised Rail Chassis
- Cummins® ISL 8.9L Engine with 380HP & 1,150 lb.-ft. Torque (G36 & M37)
- Cummins® ISL 8.9L Engine with 400HP & 1,250 lb.-ft. Torque (A40 & T42)
- 6-Speed Allison MH-3000 Automatic Transmission
- Air-Ride™ Suspension
- I-Beam Front Axle with 55° Wheel Cut
- Exhaust Brake
- Sachs® Shock Absorbers
- Dual Fuel Fills
- One-Piece Fiberglass Front & Rear Caps
- Invisible Front Paint Protection
- Full-Body Paint Package
- Automatic Leveling Jacks with Touchpad Controls
- Side-Hinged Locking Compartment Doors
- Basement Pass-Through Storage
- Easy Slide Storage Tray
- Power Entry Door & Patio Awnings with Integrated LED Lighting
- Slideout Room Topper Awnings
- Patio Light (Both Sides)
- Roof Ladder
- Frameless Dual Pane Windows
- 10,000-lb. Trailer Hitch with 7-pin Round Connector (G36, M37 & A40)
- 15,000-lb. Trailer Hitch with 7-pin Round Connector (T42)

AUTOMOTIVE & COCKPIT

- 10" Touchscreen AM/FM Dash Radio with CD/DVD Player, Bluetooth® & Back-Up Monitor
- Chrome Heated/Power Mirrors with Integrated Side View Cameras
- Push Button Start

- Leatherette Reclining/Swivel Power Adjustable Captain's Chairs (Passenger Seat has Electric Footrest)
- Driver & Passenger Overhead Storage Cabinetry
- VIP Tilt/Telescoping Smart Wheel
- Cruise Control
- Emergency Engine Start Switch
- Air Horns
- Fog Lights
- Power Solar & Privacy Shades on Windshield
- Manual Solar & Privacy Shades on Side Windows
- Solid Surface Entry Steps
- Electric Step Cover
- 275/80R 22.5" Radial Tires with Aluminum Wheels (G36, M37 & A40)
- 295/80R 22.5" Radial Tires with Aluminum Wheels (T42)

INTERIOR

- Polished Porcelain Tile Throughout
- Ceiling Ducted Whisper Air™ Central Cooling System
- LED Lighting
- High-Gloss Glazed Cabinetry with Solid Wood Raised Panel Cabinet Doors & Nickel Finish Hardware
- Solid Wood Veneer in Select Areas
- Window Solar & Privacy Shades
- Leatherette Furniture
- Passenger Side Sofa with Air Bed (G36)
- Driver Side Sofa with Air Bed (M37, A40 & T42)
- Reclining Theater Seating with Footrests (M37, A40 & T42)
- Buffet Dinette with Four (4) Chairs – Includes Two (2) Folding
- Electric Fireplace with Remote Control (G36)

INTERIOR OPTIONS

- Ensemble with Sofa & Dream Dinette® (G36)
- Expanding Sofa with Air Bed (G36)
- Passenger Side Jack-Knife Sofa (M37, A40 & T42)
- Passenger Side Sofa w/Air Bed – Euro Recliner, Desktop & Electric Fireplace with Remote Control Option Required (M37 & A40)
- Euro Recliner, Desktop & Electric Fireplace with Remote Control (M37 & A40)
- Dream Dinette® Booth

KITCHEN

- 21 cu. ft. Stainless Steel Residential Refrigerator with In-Door Ice & Water Dispenser
- Electric Induction Cooktop
- 1.9 cu. ft. Stainless Steel Over-the-Range Convection Microwave Oven
- Solid Surface Countertops & Sink Covers
- Large Double Bowl Stainless Steel Sink with Single Handle Faucet & Pull-Down Sprayer
- Designer Tile Backsplash
- 12-volt Attic Fan with Cover

BEDROOM & BATHROOM

- Denver Mattress® Pillowtop King Size Bed
- Bedspread with Throw Pillows
- Ceiling Fan in Bedroom
- USB Charging Ports in Nightstands
- Porcelain Toilet
- Oversized Full Height Shower with Glass Door
- 12-volt Attic Fan with Cover in Bathroom

BEDROOM & BATHROOM OPTION

- Power Drop-Down Hide-Away Overhead Bunk with Cotton Cloud™ Mattress

ENTERTAINMENT

- 40" LED HDTV & 55" LED Smart HDTV in Living Area (A40 & T42)

- 55" LED Smart HDTV in Living Area (G36 & M37)
- 32" LED HDTV in Cockpit Overhead (G36 & M37)
- JBL® Sound Bar with Bluetooth®
- Sony® Blu-Ray Player in Living Area & Bedroom
- 32" LED HDTV in Bedroom
- Exterior 40" LED HDTV & Sound Bar w/Bluetooth®
- Cable TV & HDMI Video Ready
- Winegard™ TRAV'LER HD Satellite Dish (HD-capable with DirecTV in US. Shaw Direct in Canada)

ELECTRICAL & PLUMBING

- Cummins Onan® RV QD 8000 Diesel Generator (G36, M37 & A40)
- Cummins Onan® RV QD 10000 Diesel Generator on Power Slideout (T42)
- Automatic Generator Start
- 50-amp Shoreline Power Cord
- 2000-watt Pure Sine Inverter/100-amp Converter
- Dual 15,000 BTU Low-Profile Ducted Air Conditioners with Two (2) Heat Pumps (G36, M37 & A40)
- Triple 15,000 BTU Low-Profile Ducted Air Conditioners with Three (3) Heat Pumps (T42)
- Energy Management System
- Multiplex Wiring Control System
- Pre-Wired for Solar Charging
- Four (4) Auxiliary House Batteries
- Battery Disconnect Switch
- Exterior GFCI Recept
- 10-gallon DSI Gas/Electric Water Heater
- Enclosed & Heated Holding Tanks
- E-Z Flow Water Panel with Whole-House Water Filtration
- Black Tank Flush System
- Outside Shower
- Stackable Washer & Dryer
- Central Vacuum System w/Toe-Kick Dustpan

IMPORTANT—PLEASE READ: This brochure reflects product design, fabrication, material, components and specifications at the date of printing, which date is disclosed below. Please visit us online at ThorMotorCoach.com or consult with your selling dealership for the latest in standards, options, specification and technical information. Photographs in the brochure may depict optional equipment or may only be available in certain floor plans. Components, appliances and the chassis may have been manufactured in a calendar year before the vehicle's designated model year. All capacities are approximate. The actual length of the vehicle may differ from that indicated in the brochure due to variances in the manufacturing processes and/or installed components. All dry weights are based on standard model features and do not include optional features or equipment. Component part and appliance manufacturers issue limited warranties covering portions of the vehicle not covered under the limited warranty we issue. Copyright Thor Motor Coach, Inc. © OH 01/04/17

YOUR LOCAL THOR MOTOR COACH DEALER

LA MESA RV
EXPERIENCE LIFE

www.lamesarv.com
800-496-8778



Made to fit.

thormotorcoach.com/venetian



P.O. Box 1486, Elkhart, IN 46515 Sales Department: 800.860.5658 Customer Service: 877.855.2867