



*Mad as Hell* *Fit*



# CHATEAU<sup>®</sup>

**SUPER C BY THOR MOTOR COACH**

*Wherever your pursuits may take you, let us be the catalyst that makes the journey a memorable one.*

# Floor Plans

## 35SB

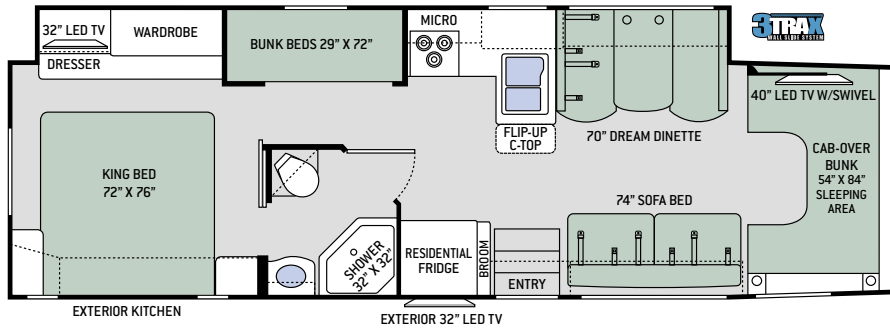

## 35SD

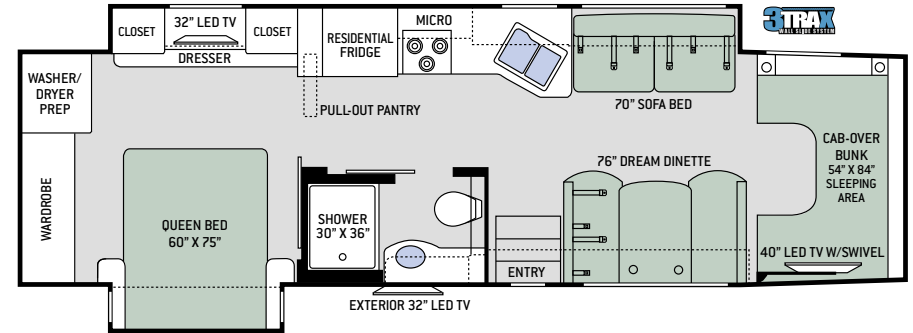

## 35SF

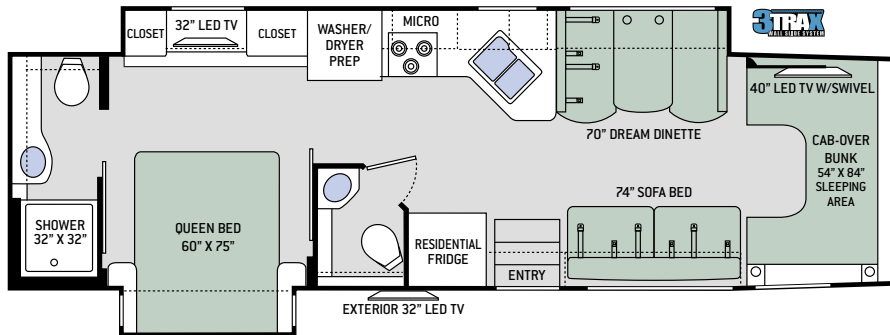

## 35SM

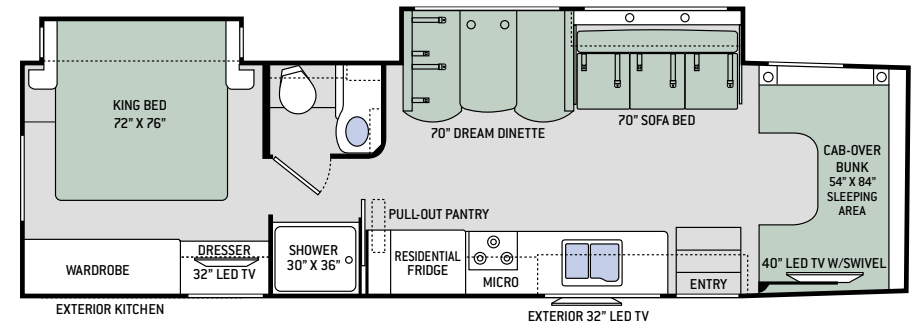

# Specifications

	35SB	35SD	35SF	35SM
Chassis	Ford	Ford	Ford	Ford
Gross Vehicle (GVWR)	19,500	19,500	19,500	19,500
Gross Combined (GCWR)	35,000	35,000	35,000	35,000
Wheel Base	248-5/8"	258-5/8"	258-5/8"	258-5/8"
Exterior Length (w/o ladder)	36'-8"	36'-10"	36'-10"	36'-10"
Exterior Height (w/ AC)	12'-6"	12'-6"	12'-6"	12'-6"
Exterior Width (w/o mirrors)	99"	99"	99"	99"
Interior Height (living area)	84"	84"	84"	84"
Awning Size	19'	14'	14'	16'
Front/Rear Fuel (gal)	28 / 40	28 / 40	28 / 40	28 / 40
LPG (lbs)	68.2	68.2	68.2	68.2
Fresh/Waste/Gray Water (gal)	75 / 40 / 40	75 / 40 / 40	75 / 40F- 31R / 40	75 / 40 / 40
Water Heater (gal)	6	6	6	6
Furnace (BTUs)	30,000	30,000	30,000	30,000
Exterior Storage Capacity (cu. ft.)	93 / 128*	100	117	109 / 134*

\*Without Exterior Kitchen



3TRAX™ is our in-wall slideout system, housing all the moving and mechanical parts within the sidewall of the motorhome. This triple track design supports large rooms, like those found in full-wall slideouts, ensuring simple, reliable, maintenance-free operation. What sets 3TRAX™ apart is the patented rail system, in-floor roller guides and electric motor design. For more information, visit [thormotorcoach.com/3TRAX](http://thormotorcoach.com/3TRAX).

# Interior Decor



FADE TO BLACK



KITCHEN & DINETTE COUNTERTOP



HIGH-GLOSS GLAZED MILAN



WINTER OPAL



BED & BATH COUNTERTOP



HIGH-GLOSS GLAZED NEWPORT



RESIDENTIAL VINYL FLOORING



HIGH-GLOSS GLAZED PACIFIC

# Exterior Graphics



CHERRY TRAILS FULL-BODY PAINT



WINDING WATERS FULL-BODY PAINT

# Features

## CONSTRUCTION & EXTERIOR

- Ford® F-550 Chassis – 6.7L Power Stroke® V8 Turbo Diesel, 300HP & 660 lb.-ft. Torque – TorqShift® 6-Speed SelectShift® Automatic Transmission
- Welded Tubular Steel Floor
- Welded Tubular Aluminum Roof & Sidewall Cage Construction
- Premium One-Piece TPO Roof
- Front and Rear Fiberglass Caps
- Full-Body Paint Package with Gel Coated Sidewalls
- Automatic Leveling Jacks with Touchpad Controls
- Rotocast Storage Compartments
- Flush Mount Radius Compartment Doors
- Power Patio Awning with Integrated LED Lighting
- Slideout Room Awnings
- 3TRAX™ Wall Slide System (35SB, 35SD & 35SF)
- Roof Ladder
- Electric Entry Step
- Frameless Windows
- 10,000-lb. Trailer Hitch with 7-pin Round Connector

## AUTOMOTIVE & COCKPIT

- Ford® SYNC® with MyFord, 911 Assist®, AppLink®, CD/MP3 and SiriusXM® Capability
- Heated/Remote Exterior Mirrors
- Side View Camera System
- Rear View Mirror with Back-Up Monitor
- Luxury Cloth Captain's Chairs with Adjustable Headrest
- Emergency Engine Start Switch
- Adjustable Accelerator & Brake Pedals
- Power Windows & Door Locks
- Keyless Entry System
- Windshield Privacy Curtain
- Fiberglass Running Boards
- Valve Stem Extenders
- Stainless Steel Wheel Liners

## INTERIOR

- Rubber Tread Entry Steps with Lighted Step Well
- Residential Vinyl Flooring Throughout
- 84" Interior Ceiling Height
- LED Lighting
- Ceiling Ducted Air Conditioning System
- High-Gloss Glazed Cabinetry with Solid Wood Raised Cabinet Doors, Hidden Hinges & Nickel Finish Hardware
- Window Solar & Privacy Roller Shades in Living Room
- Leatherette Sleeper Sofa
- Leatherette Dream Dinette® Booth
- Pressed Laminate Countertops

## INTERIOR OPTIONS

- Single Child Safety Tether in Dinette
- Dual Child Safety Tethers in Dinette

## KITCHEN

- 16 cu. ft. Stainless Steel Residential Refrigerator w/Ice Maker
- 3-Burner Gas Cooktop/Oven with Bi-Fold Cover
- Stainless Steel 30" Over-the-Range Convection Microwave Oven
- Solid Surface Countertops & Sink Covers
- Stainless Steel Double Bowl Sink with Single Handle Faucet & Pull-Down Sprayer
- Pop-Up Countertop Outlet
- Pantry (35SD & 35SM)
- Waste Basket
- 12-volt Attic Fan with Cover (35SB, 35SD & 35SF)

## BEDROOM & BATHROOM

- Denver Mattress® King Size Bed (35SB & 35SM)
- Denver Mattress® Queen Size Bed (35SD & 35SF)
- Headboard, Bedspread & Pillow Shams
- Window Privacy Shades in Bedroom
- Bunk Beds in Hallway Slideout (35SB)
- Shower with Glass Door
- Stainless Steel Bathroom Sink
- Porcelain Toilet

## ENTERTAINMENT

- 40" LED TV on Manual Swivel in Cab-Over
- Blu-Ray Player in Living Area
- 32" LED TV in Bedroom
- Two (2) 15.5" LED TVs & DVD Player in Bunk Bed Area (35SB)
- Exterior 32" LED TV on Manual Swivel
- Bluetooth® Coach Radio System with Exterior Speakers
- Cable TV Ready
- Digital TV Antenna
- Power Charging Center for Electronics
- Exterior Kitchen with 2.6 cu. ft. Refrigerator & Sink (35SB & 35SM)

## ENTERTAINMENT OPTIONS

- Cab-Over Entertainment Center with 50" LED TV & Sound Bar (IPO 40" LED TV)
- Storage Area with Shelf IPO Exterior Kitchen (35SB & 35SM)

## ELECTRICAL & PLUMBING

- Onan® RV QG 6000 Diesel Generator
- Automatic Generator Start
- 50-amp Detachable Shoreline Power Cord
- Automatic Shoreline-to-Generator Transfer Switch
- 1800-watt Inverter
- Multiplex Wiring Control System
- Pre-wired for Solar Charging
- Exterior LP Connection
- Two (2) 13,500 BTU Roof Air Conditioners
- Dual Auxiliary House Batteries with Battery Tray that Holds up to Four (4) Batteries
- Battery Disconnect Switch
- Whole Coach Water Filtration System
- 6-gallon DSI Gas/Electric Water Heater
- Water Heater Bypass System
- Enclosed & Heated Holding Tanks
- Black Tank Flush System
- Outside Shower
- Systems Control Center

**IMPORTANT—PLEASE READ:** This brochure reflects product design, fabrication, material, components and specifications at the date of printing, which date is disclosed below. **Please visit us online at [ThorMotorCoach.com](http://ThorMotorCoach.com) or consult with your selling dealership for the latest in standards, options, specification and technical information.** Photographs in the brochure may depict optional equipment or may only be available in certain floor plans. Components, appliances and the chassis may have been manufactured in a calendar year before the vehicle's designated model year. All capacities are approximate. The actual length of the vehicle may differ from that indicated in the brochure due to variances in the manufacturing processes and/or installed components. All dry weights are based on standard model features and do not include optional features or equipment. Component part and appliance manufacturers issue limited warranties covering portions of the vehicle not covered under the limited warranty we issue. Copyright Thor Motor Coach, Inc. © MY 04/15/17

YOUR LOCAL THOR MOTOR COACH DEALER

**LAMESA RV**  
EXPERIENCE LIFE

[www.lamesarv.com](http://www.lamesarv.com)  
**800-496-8778**



**Made to fit.**

[thormotorcoach.com/chateau-super-c](http://thormotorcoach.com/chateau-super-c)



P.O. Box 1486, Elkhart, IN 46515

Sales Department: 800.860.5658

Customer Service: 877.855.2867